

EXPLANATION

- Test hole, log in table 3
- Domestic or stock well
- Public supply, industrial, or irrigation well
- Commercial test hole
- ▽ Surface-water sampling point, analysis in table 5
- Modifications used with above symbols
- Specific conductance in table 1
- Water-level measurements in table 2
- Log in table 3
- Chemical analysis in table 4
- ² More than one well at this location

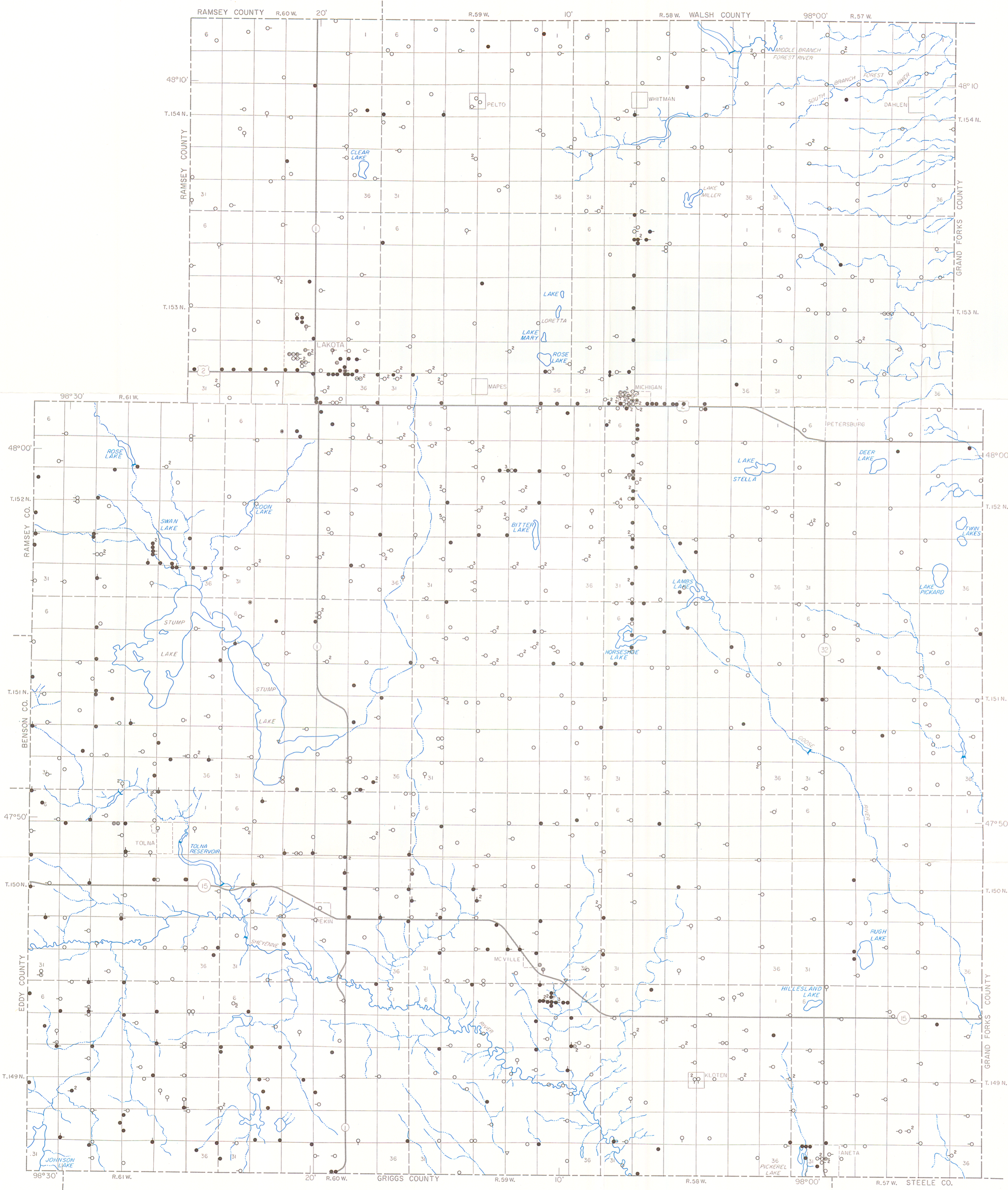

BASE PREPARED FROM NORTH DAKOTA STATE HIGHWAY DEPARTMENT COUNTY HIGHWAY MAPS

0 2 4 6 8 10 MILES

0 2 4 6 8 10 KILOMETERS

PLATE 1.—MAP SHOWING LOCATION OF WELLS AND TEST HOLES IN NELSON COUNTY, NORTH DAKOTA

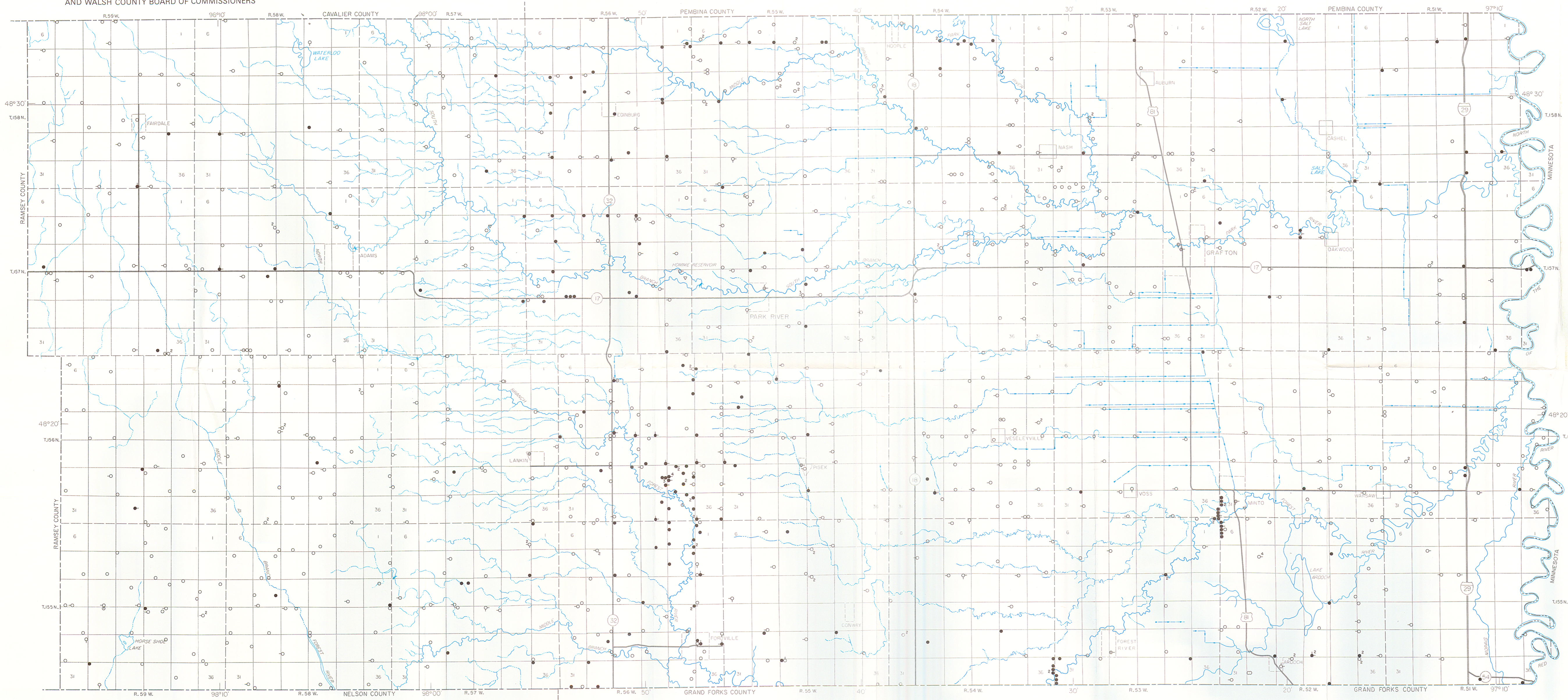

- EXPLANATION**
- Test hole, log in table 3
 - Domestic or stock well
 - Public supply, industrial, or irrigation well
 - Commercial test hole
 - ▽ Surface-water sampling point, analysis in table 5
- Modifications used with above symbols**
- Specific conductance in table 1
 - Water-level measurements in table 2
 - Log in table 3
 - Chemical analysis in table 4
 - More than one well at this location

BASE PREPARED FROM NORTH DAKOTA STATE HIGHWAY DEPARTMENT COUNTY HIGHWAY MAPS

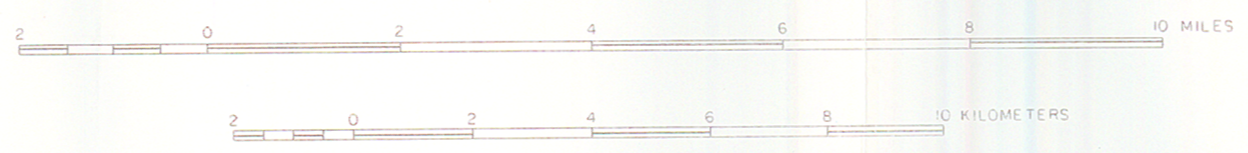

PLATE 2.—MAP SHOWING LOCATION OF WELLS AND TEST HOLES IN WALSH COUNTY, NORTH DAKOTA