

EXPLANATION

- Domestic or stock well
- ⊙ Irrigation, industrial, or municipal well
- Test hole drilled by North Dakota State Water Commission or other government agency
- ⊙ Commercial test hole
- Spring
- △ Surface water sampling point

Tick above symbol (○) indicates waterlevel measurement(s) obtained, to right of symbol indicates chemical analyses made, below symbol indicates drillers log obtained, to left of symbol indicates specific conductance determined

Number indicates more than one well at that location. DL and Sh distinguish data given in Devils Lake (Paulson and Akin, 1964) and Sheyenne (Froelich, 1964) reports, respectively

OIL indicates oil exploration test hole

Base prepared from North Dakota Highway Department county highway maps

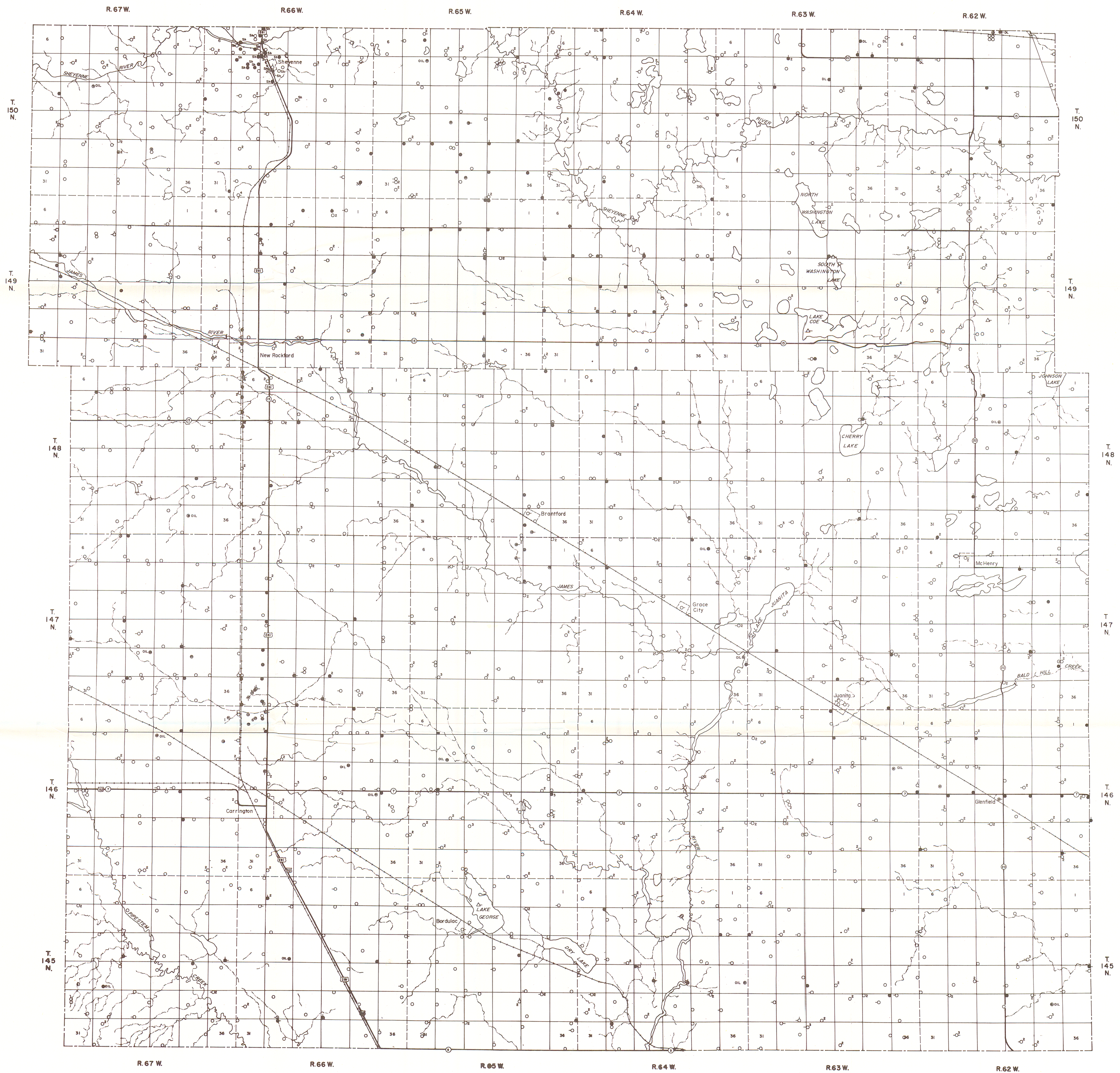

LOCATION OF WELLS, SPRINGS, AND TEST HOLES IN EDDY AND FOSTER COUNTIES, NORTH DAKOTA