

FIGURE 4. MAP OF BARNES COUNTY SHOWING LOCATION OF TEST HOLES AND SELECTED WELLS

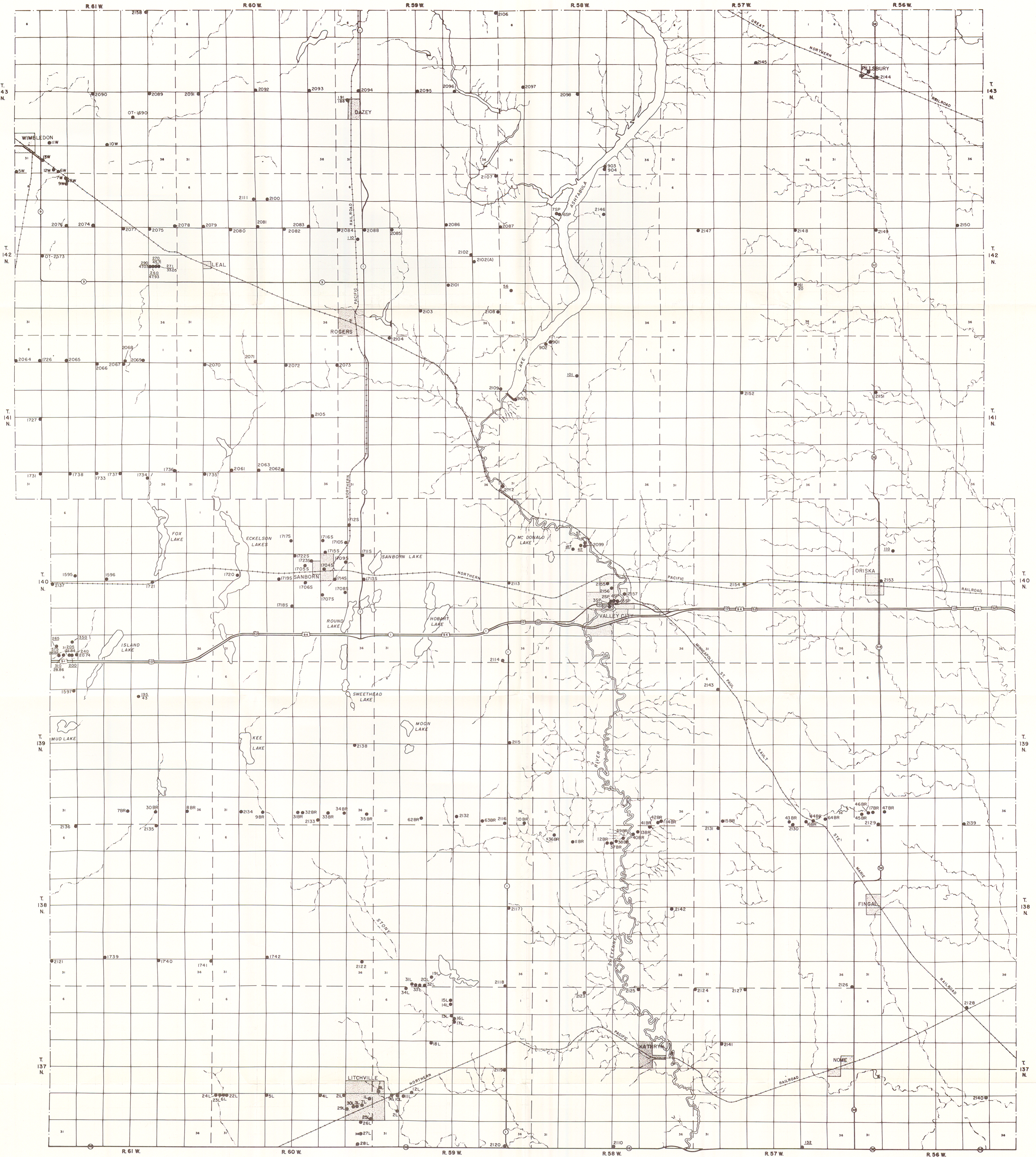

FIGURE 4
MAP OF BARNES COUNTY SHOWING LOCATION OF
TEST HOLES AND SELECTED WELLS

EXPLANATION

- 2098
Test hole drilled as part of county study
- 31L
Test hole not drilled as part of the county study; BR, Bureau of Reclamation; L, Litchville ground-water study (1928); S, Sedoros ground-water study (1963); SP, special project (1965); W, Wimbeldon ground-water study (1948).
- 184
Privately owned well for which log is available. Upper number indicates depth of well in feet; lower number indicates depth to water in feet.
- OT-2,573
Oil Test. Number indicates total depth.

Base prepared from N. Dak. Highway Department county highway maps.

1 5 0 1 2 3 Miles
SCALE

FIGURE 3. MAP OF BARNES COUNTY SHOWING LOCATION OF WELLS AND SPRINGS

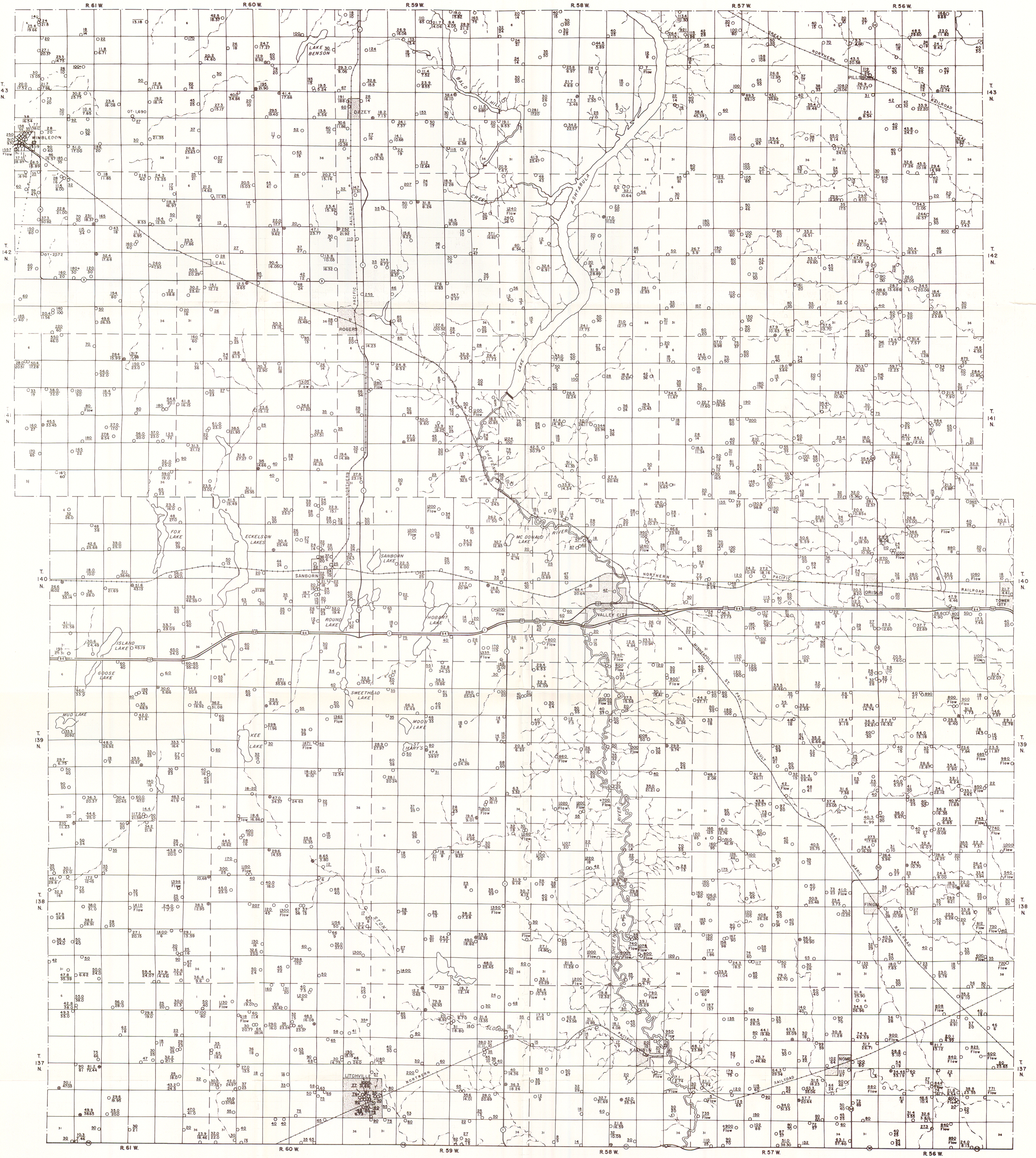

FIGURE 3

MAP OF BARNES COUNTY SHOWING LOCATION OF WELLS AND SPRINGS

EXPLANATION

- 35
Domestic, stock, public supply, or irrigation well.
- 31.8
Upper number indicates depth of well in feet; lower number indicates depth to water.
- Observation well
- Spring

Base prepared from N. Dak. Highway Department county highway maps.

